

客户图

NOTES:

1. FINISH:
 - 1.1 HOUSING: LCP BLACK,UL94V-0.
 - 1.2 CONTACT: BeCu,GOLD (SEE P/N) PLATED IN CONTACT AREA, MATTE TIN PLATED IN SOLDER AREA, 50u" MIN. NICKEL UNDERPLATED OVERALL.
2. ELECTRICAL:
 - 2.1 CURRENT RATING: 1.34 A PER PIN(4 PINS POWERED).
 - 2.2 OPERATION TEMPERATURE: -55°C TO +125°C.
3. ORDER INFORMATION:

66B2-F XXX XX 037 R 01

Pin 数码	端子电镀:	塑胶高度:	包装方式:
040=4*10PIN	S0=Gold Flash/Tin	037=3.73mm	R=载带包装
~	S1=1u" Gold/Tin		
400=4*100PIN	S2=3u" Gold/Tin		
	S3=5u" Gold/Tin		
	S4=10u" Gold/Tin		
	S6=30u" Gold/Tin		

TABLE1:

No. OF PIN	A	B	C	D
040=4x10PIN	5.715	8.595	11.07	8.52
080=4x20PIN	12.065	14.945	17.42	14.87
120=4x30PIN	18.415	21.295	23.77	21.22
160=4x40PIN	24.765	27.645	30.12	27.57
200=4x50PIN	31.115	33.995	36.47	33.92
240=4x60PIN	37.465	40.345	42.82	40.27
280=4x70PIN	43.815	46.695	49.17	46.62
320=4x80PIN	50.165	53.045	55.52	52.97
360=4x90PIN	56.515	59.395	61.87	59.32
400=4x100PIN	62.865	65.745	68.22	65.67

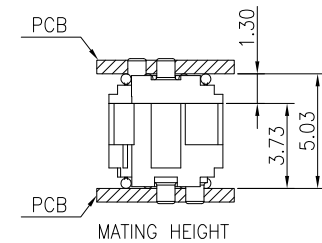
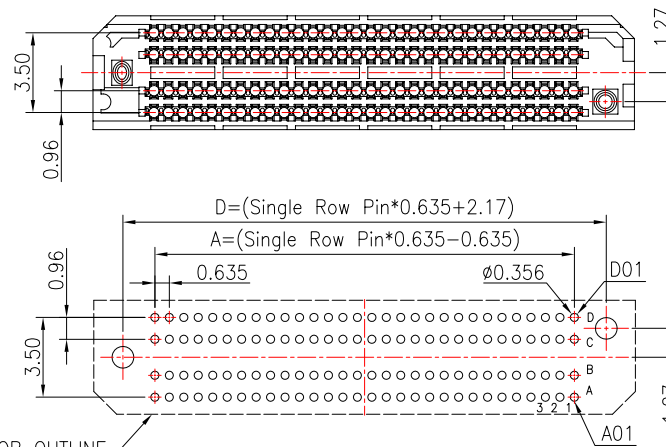
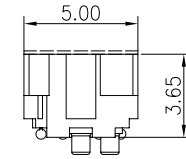
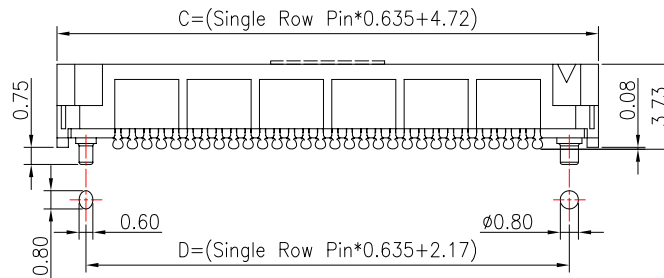
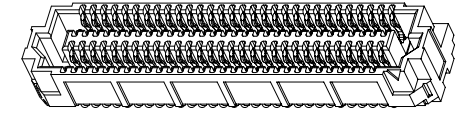
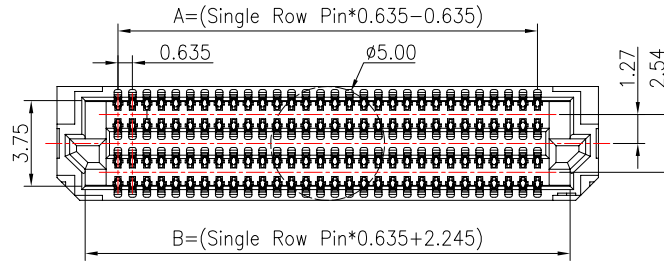

CONNECTOR OUTLINE RECOMMENDED PCB LAYOUT(TOP SIDE)
PCB BOARD TOLERANCE ±0.05

REV	DATE	MODIFICATION DESCRIPTION	CHANGE	APPROVE	OPERATION	DRAW	WLY	SCALE	UNIT	mm	SCALE	1:1	PROJ.	SIZE	A4	PART NO.	66B2-FXXXXX037R01
AO		NEW			X.X ±0.40	DESIGN	Jensen	2021.09.23						SHEET	1/1	TITLE:	0.635mm BTB 母座直立式 SMT
					X.XX ±0.25	CHECK	Jack	2021.09.23						PROJ.	DRAW NO.	SP-568	
					X.XXX ±0.15	APPROVE	Andy	2021.09.23									
					Angle ±3°												
					DIM. TOL												

SOLEPIN 东莞市硕品电子有限公司
Professional connector manufacturer DONGGUAN SOLEPIN ELECTRONICS CO., LTD.

SIZE A4 PART NO. 66B2-FXXXXX037R01
SHEET 1/1 TITLE: 0.635mm BTB 母座直立式 SMT
PROJ. DRAW NO. SP-568

客户图

NOTES:

1. FINISH:
 - 1.1 HOUSING: LCP BLACK,UL94V-0.
 - 1.2 CONTACT: BeCu,GOLD (SEE P/N) PLATED IN CONTACT AREA, MATTE TIN PLATED IN SOLDER AREA, 50u" MIN. NICKEL UNDERPLATED OVERALL.
2. ELECTRICAL:
 - 2.1 CURRENT RATING: 1.34 A PER PIN(4 PINS POWERED).
 - 2.2 OPERATION TEMPERATURE: -55°C TO +125°C.
3. ORDER INFORMATION:

66B2-M XXX XX 013 R 01

Pin数码	端子电镀:	塑胶高度:	包装方式:
040=4*10PIN	S0=Gold Flash/Tin	013=1.30mm	R=载带包装
~	S1=1u" Gold/Tin		
400=4*100PIN	S2=3u" Gold/Tin		
	S3=5u" Gold/Tin		
	S4=10u" Gold/Tin		
	S6=30u" Gold/Tin		

TABLE1:

No. OF PIN	A	B	C	D
040=4x10PIN	5.715	8.395	11.07	8.52
080=4x20PIN	12.065	14.745	17.42	14.87
120=4x30PIN	18.415	21.095	23.77	21.22
160=4x40PIN	24.765	27.445	30.12	27.57
200=4x50PIN	31.115	33.795	36.47	33.92
240=4x60PIN	37.465	40.145	42.82	40.27
280=4x70PIN	43.815	46.495	49.17	46.62
320=4x80PIN	50.165	52.845	55.52	52.97
360=4x90PIN	56.515	59.195	61.87	59.32
400=4x100PIN	62.865	65.545	68.22	65.67

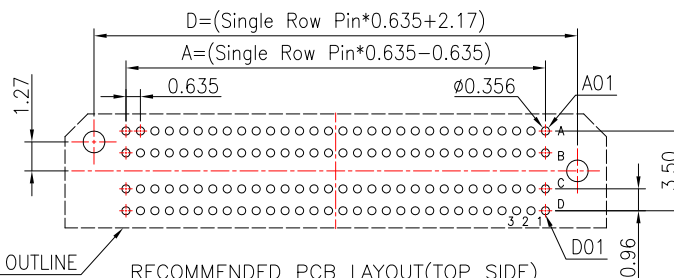
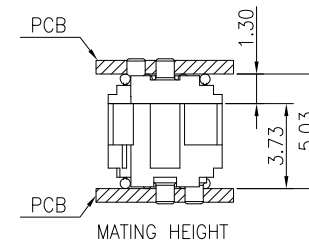
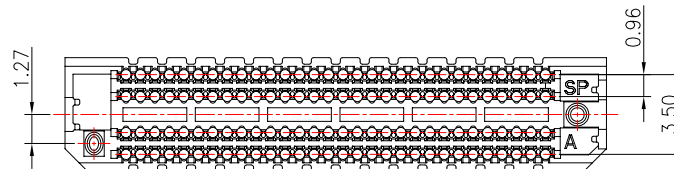
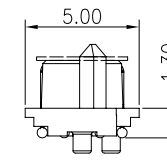
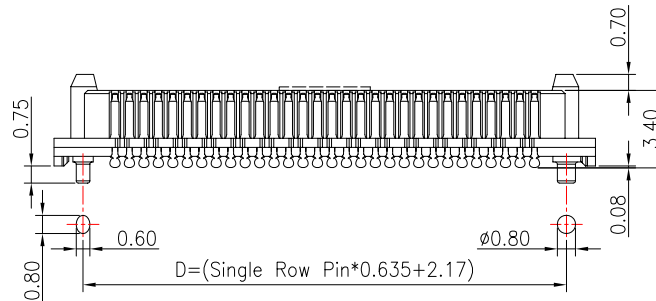
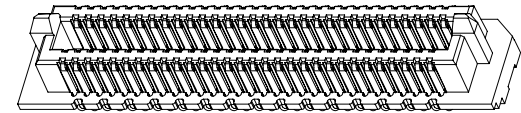
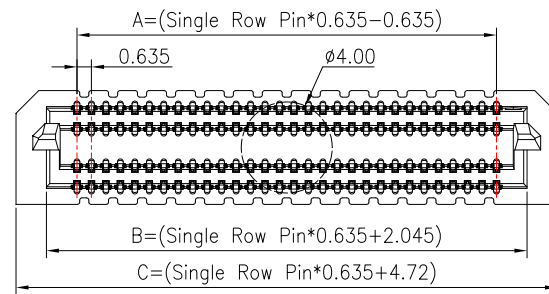

CONNECTOR OUTLINE RECOMMENDED PCB LAYOUT(TOP SIDE)
PCB BOARD TOLERANCE ±0.05

REV	DATE	MODIFICATION DESCRIPTION	CHANGE	APPROVE	OPERATION	DRAW	WLY	SCALE	UNIT	mm	SCALE	1:1	PROJ.	SIZE	A4	PART NO.	66B2-MXXXXX013R01
AO		NEW			X.X ±0.40	DESIGN	Jensen	2021.09.23						SHEET	1/1	TITLE:	0.635mm BTB 公头直立式 SMT
					X.XX ±0.25	CHECK	Jack	2021.09.23						PROJ.	DRAW NO.	SP-567	
					X.XXX ±0.15	APPROVE	Andy	2021.09.23									
					Angle ±3°												
					DIM. TOL												

SOLEPIN 东莞市硕品电子有限公司
Professional connector manufacturer DONGGUAN SOLEPIN ELECTRONICS CO., LTD.

SIZE A4 PART NO. 66B2-MXXXXX013R01
SHEET 1/1 TITLE: 0.635mm BTB 公头直立式 SMT
PROJ. DRAW NO. SP-567