

# 客户图

## NOTES:

.FINISH:

1.1 HOUSING: PPS BLACK, UL94V-0.

1.2 CONTACT: COPPER ALLOY, GOLD (SEE P/N) PLATED IN CONTACT AREA, GOLD FLASH PLATED IN SOLDER AREA, 50u"MIN NICKEL UNDERPLATED OVERALL.

## 2. ELECTRICAL:

2.1 CURRENT RATING: 4.0 AMP,AC/DC

2.2 DIELECTRIC WITHSTANDING VOLTAGE: 750V,AC/Minute

2.3 CONTACT RESISTANCE: 100mΩ MAX.

2.4 INSULATION RESISTANCE: 1000 mΩ Min

2.5 Operation Temperature:-55°C to +200°C

## 3.SALT SPRAY TEST:

3.1 CONCENTRATION IS 5%, THE TEMPERATURE IS 35±2°C, TEST TIME 8H MIN,NO OXIDATION OR RUST

## 4.ORDER INFORMATION:

61H8- S XXX XX 156 C 01

180° 直插

Pin数码

SEE TABLE

004=2\*2PIN

~

150=2\*75PIN

端子电镀:

S1=1u" Gold/Tin

S2=3u" Gold/Tin

S5=15u" Gold/Tin

S6=30u" Gold/Tin

塑胶高度:

156=15.60mm

包装方式:

C=TRAY

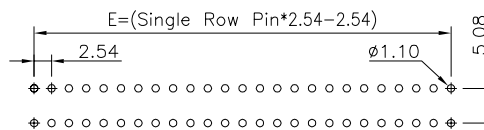
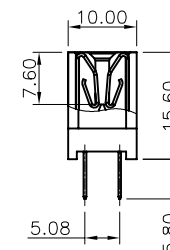
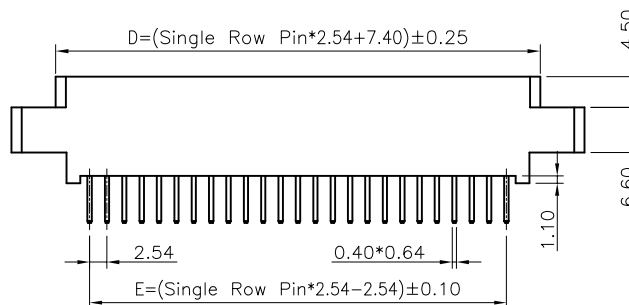
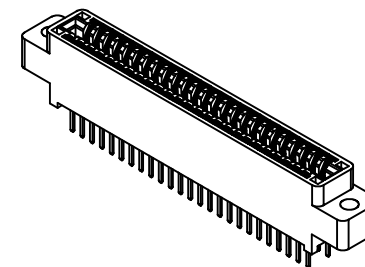
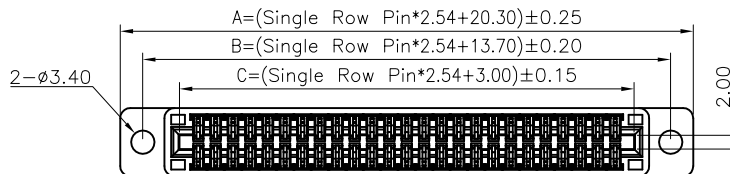

RECOMMENDED PCB LAYOUT(TOP SIDE)  
PCB BOARD TOLERANCE  $\pm 0.05$

No. OF PIN	A	B	C	D	E
004=2x02PIN	25.38	18.78	8.08	12.48	2.54
006=2x03PIN	27.92	21.32	10.62	15.02	5.08
008=2x04PIN	30.46	23.86	13.16	17.56	7.62
010=2x05PIN	33.00	26.40	15.70	20.10	10.16
012=2x06PIN	35.54	28.94	18.24	22.64	12.70
014=2x07PIN	38.08	31.48	20.78	25.18	15.24
016=2x08PIN	40.62	34.02	23.32	27.72	17.78
018=2x09PIN	43.16	36.56	25.86	30.26	20.32
020=2x10PIN	45.70	39.10	28.40	32.80	22.86
030=2x15PIN	58.40	51.80	41.10	45.50	35.56
050=2x25PIN	83.80	77.20	66.50	70.90	60.96
.....					
150=2x75PIN	210.80	204.20	193.50	197.90	187.96

				OPERATION		DRAW		WLY		2023.05.30		<b>SOLEPIN 东莞市硕品电子有限公司</b> Professional connector manufacturer DONGGUAN SOLEPIN ELECTRONICS CO., LTD.			
				X.X	$\pm 0.40$	DESIGN		Jensen		2023.05.30					
				X.XX	$\pm 0.25$	CHECK		Jack		2023.05.30		SHEET	1/1	TITLE:	2.54x5.08mm 金手指 DIP 180°
AO		NEW		X.XXX	$\pm 0.15$	APPROVE		Andy		2023.05.30		PROJ.	$\phi$	DRAW NO.	SP-948
REV	DATE	MODIFICATION DESCRIPTION		CHANGE	APPROVE	DIM.	TOL	UNIT	mm	SCALE	1:1				

# 客户图

## NOTES:

1. FINISH:
  - 1.1 HOUSING: PPS BLACK, UL94V-0.
  - 1.2 CONTACT: COPPER ALLOY, GOLD (SEE P/N) PLATED IN CONTACT AREA, GOLD FLASH PLATED IN SOLDER AREA, 50u"MIN NICKEL UNDERPLATED OVERALL.
2. ELECTRICAL:
  - 2.1 CURRENT RATING: 4.0 AMP, AC/DC
  - 2.2 DIELECTRIC WITHSTANDING VOLTAGE: 750V, AC/Minute
  - 2.3 CONTACT RESISTANCE: 100mΩ MAX.
  - 2.4 INSULATION RESISTANCE: 1000 mΩ Min
  - 2.5 Operation Temperature: -55°C to +200°C
3. SALT SPRAY TEST:
  - 3.1 CONCENTRATION IS 5%, THE TEMPERATURE IS 35±2°C, TEST TIME 8H MIN, NO OXIDATION OR RUST
4. ORDER INFORMATION:

61H8- R XXX XX 156 C 01

90° 弯插

Pin 数码	端子电镀:	塑胶高度:	包装方式:
SEE TABLE	S1=1u" Gold/Tin	156=15.60mm	C=TRAY
004=2*2PIN	S2=3u" Gold/Tin		
~	S5=15u" Gold/Tin		
150=2*75PIN	S6=30u" Gold/Tin		

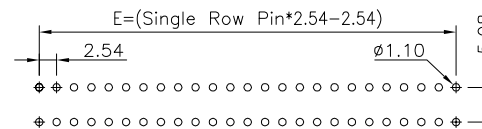
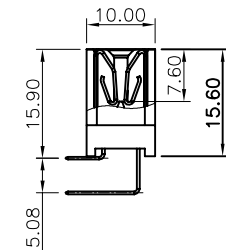
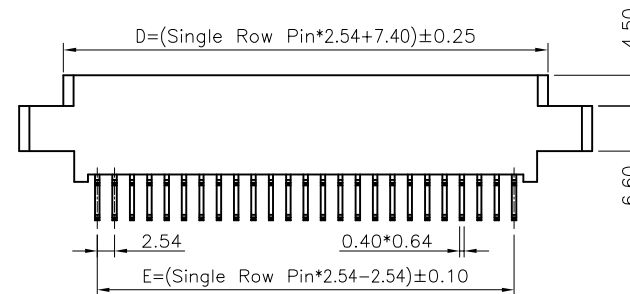
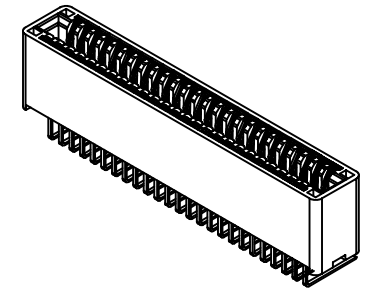
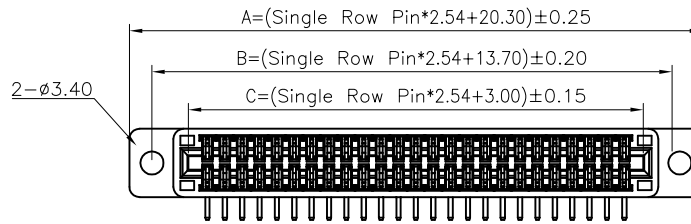

RECOMMENDED PCB LAYOUT (TOP SIDE)  
PCB BOARD TOLERANCE ±0.05

No. OF PIN	A	B	C	D	E
004=2x02PIN	25.38	18.78	8.08	12.48	2.54
006=2x03PIN	27.92	21.32	10.62	15.02	5.08
008=2x04PIN	30.46	23.86	13.16	17.56	7.62
010=2x05PIN	33.00	26.40	15.70	20.10	10.16
012=2x06PIN	35.54	28.94	18.24	22.64	12.70
014=2x07PIN	38.08	31.48	20.78	25.18	15.24
016=2x08PIN	40.62	34.02	23.32	27.72	17.78
018=2x09PIN	43.16	36.56	25.86	30.26	20.32
020=2x10PIN	45.70	39.10	28.40	32.80	22.86
030=2x15PIN	58.40	51.80	41.10	45.50	35.56
050=2x25PIN	83.80	77.20	66.50	70.90	60.96
.....					
150=2x75PIN	210.80	204.20	193.50	197.90	187.96

				OPERATION		DRAW		WLY		2023.05.30		<b>SOLEPIN 东莞市硕品电子有限公司</b> Professional connector manufacturer DONGGUAN SOLEPIN ELECTRONICS CO., LTD.			
				X.X	±0.40	DESIGN		Jensen		2023.05.30					
				X.XX	±0.25	CHECK		Jack		2023.05.30		SHEET	1/1	TITLE:	2.54x5.08mm 金手指 90° 弯插
AO		NEW		Angle		APPROVE		Andy		2023.05.30		PROJ.	☯	DRAW NO.	SP-949
REV	DATE	MODIFICATION DESCRIPTION		CHANGE	APPROVE	DIM.	TOL	UNIT	mm	SCALE	1:1				