

客户图

Features:

1. Material: Copper alloy;
2. Finished: Tin-plated over nickel;
3. Used in H2502-XX 2502S-XX
4. Wire range: #20~#26 AWG

Specification:

- Current rating: 3A AC/DC Max
 Voltage rating: 250V AC(RMS) or 250V DC Max
 Contact resition: 30MΩ Max
 Insulation resistence: 1000MΩ Min
 Dielectric withstanding coltage: 1500V AC/minute
 Ambient tempetature rang: -40°C~105°C

Diensional infotmation(mm)

Circuits	Wire range	DIM A	DIM B	DIM C	DIM D
H2501-01	#20~#22	1.97	2.33	1.94	2.14
H2501-02	#26~#26	1.39	2.12	2.00	1.45

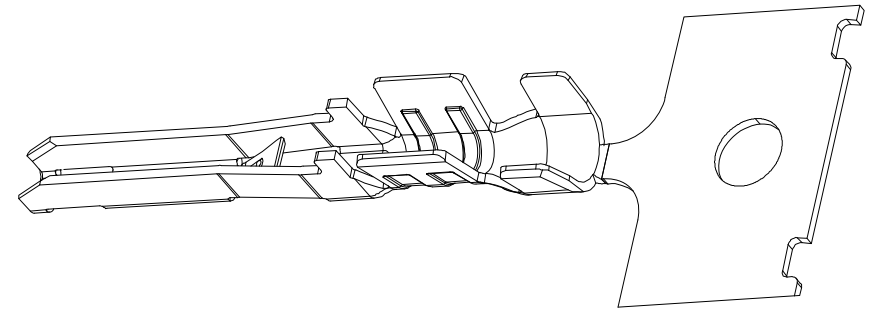
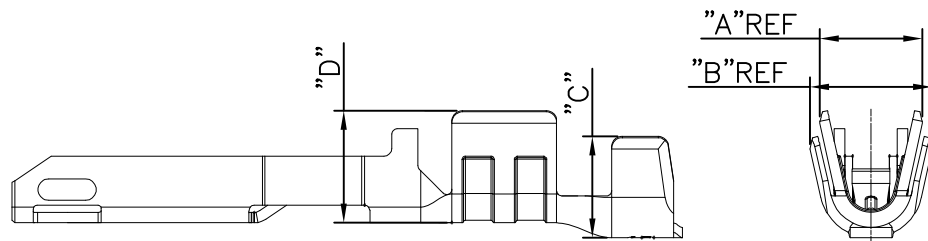
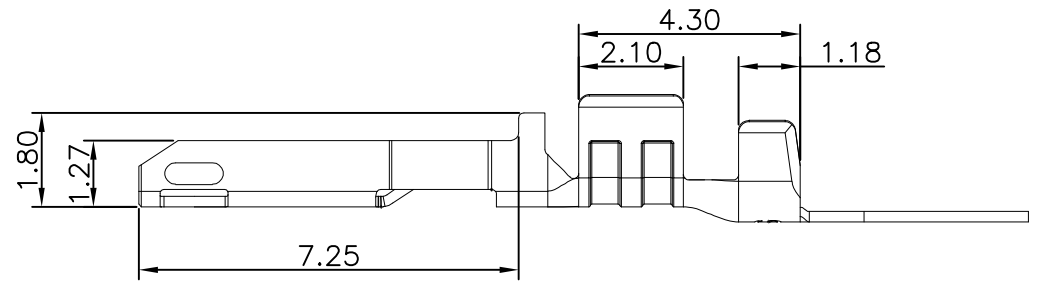
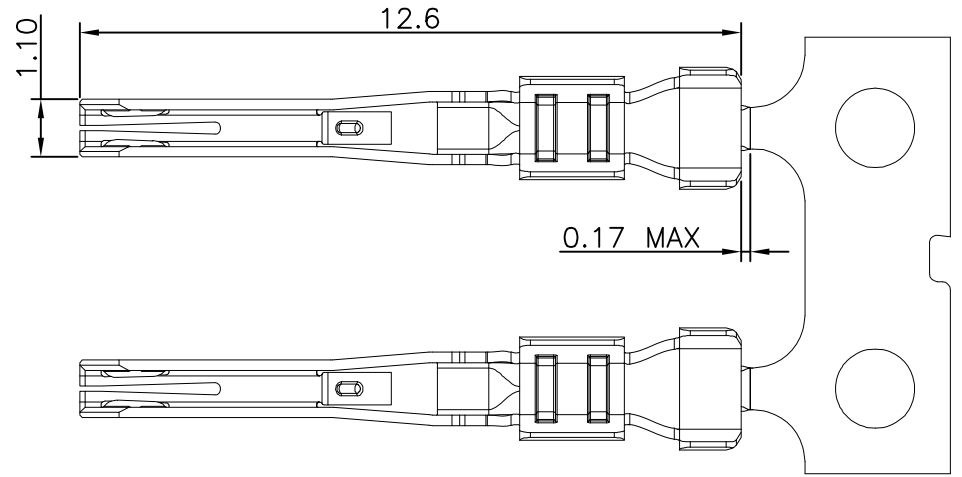

REV		DATE	MODIFICATION DESCRIPTION	CHANGE	APPROVE	DIM.	TOL	UNIT	mm	SCALE	1:1	PROJ.	SIZE	A4	PART NO.	TITLE:	H2501-XX
AO			NEW			Angle	±1°						SHEET	1/1			
													PROJ.	⌀	DRAW NO.	SP-670	

SOLEPIN 东莞市硕品电子有限公司
 Professional connector manufacturer DONGGUAN SOLEPIN ELECTRONICS CO., LTD.

客户图

Features:

- 1.4~16 circuits available;
- 2.Material:PA66+35%GF UL 64V-0
- 3.ACCEPTS H2501T-XX TERRMINAL:
- 4.Mates with H2503-XX,H2504-XX;
- 5.Coloe:Black/Natural

Specification:

- Current rating:6.5A AC/DC Max
- Voltage rating:250V AC(RMS) or 250V DC Max
- Contact resition:30MΩ Max
- Insulation resisteace:1000MΩ MIn
- Dielectric withstanding coltage:1500V AC/minute
- Ambient tempetature rang:-40℃~105℃

Diensional infotmation(mm)

Circuits	DIM A	DIM B
4	7.70	2.50
6	10.20	5.00
8	12.70	7.50
10	15.20	10.00
12	17.70	12.50
14	20.20	15.00
16	22.70	17.50

Ordering Infotmation

Part No	Feature	coloe
H2502-XX-01	KEY A	Black
H2502-XX-02	KEY B	Natural

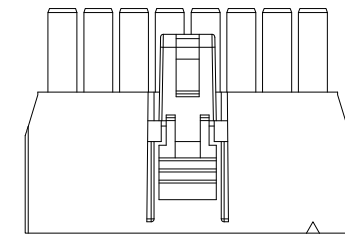
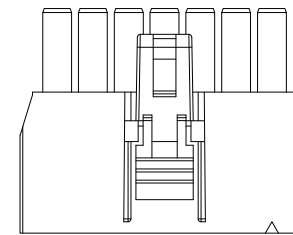
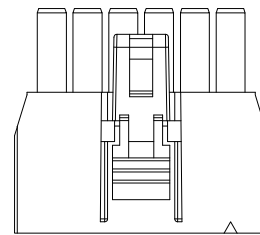
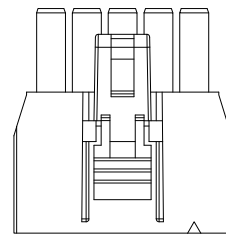
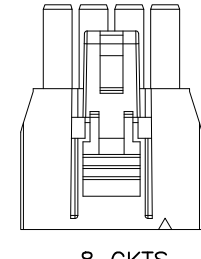
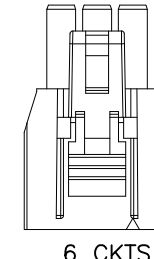
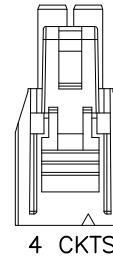
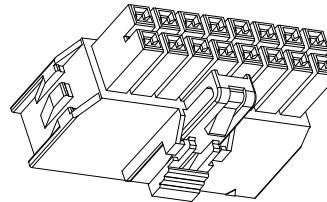
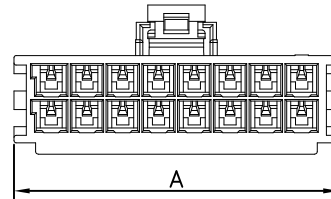
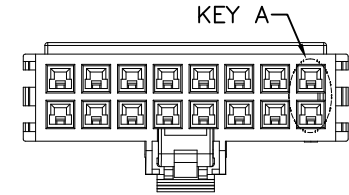
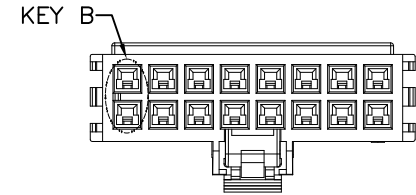
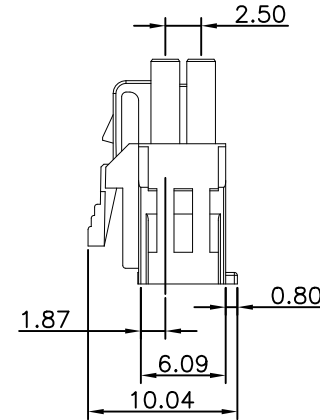
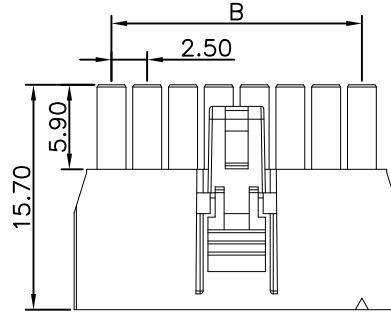

10 CKTS

12 CKTS

14 CKTS

16 CKTS

REV	DATE	MODIFICATION DESCRIPTION	CHANGE	APPROVE	OPERATION	DRAW	WLY	SCALE	UNIT	mm	SCALE	1:1	PROJ.	SIZE	A4	PART NO.	TITLE:	H2502-XX
AO		NEW			X.X ±0.40	DESIGN	Jensen	2019.03.15						SOLEPiN	东莞市硕品电子有限公司			
					X.XX ±0.25	CHECK	Jack	2019.03.15						Professional connector manufacturer	DONGGUAN SOLEPIN ELECTRONICS CO., LTD.			
					X.XXX ±0.15	APPROVE	Andy	2019.03.15						SHEET	1/1			
					Angle ±1°									PROJ.	DRW NO.			
					DIM. TOL													

客户图

Features:

- 1.4~16 circuits available;
- 2.Material:LCP UL 64V-0 Black/Natural
- 3.PIN Material:Brass tin-plated,SQ0.64;
- 4.Mates with H2502-XX;

Specification:

- Current rating:8A at 10A
- Voltage rating:400V AC(RMS) or 400V DC Max
- Contact resition:10MΩ Max
- Insulation resisteace:100MΩ Min
- Dielectric withstanding coltage:1800V AC/minute
- Ambient tempetature rang:-40°C~105°C

Diensional infotmation(mm)

Circuits	DIM A	DIM B
4	5.94	2.50
6	8.44	5.00
8	10.94	7.50
10	13.44	10.00
12	15.94	12.50
14	18.44	15.00
16	20.94	17.50

Ordering Infotmation

Part No	Feature	coloe
H2503-XX-A	KEY A	Black
H2503-XX-B	KEY B	Natutal

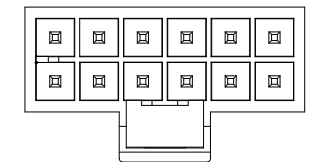
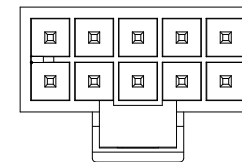
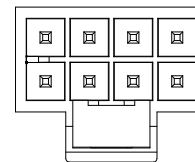
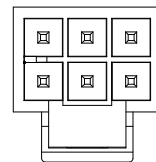
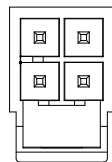
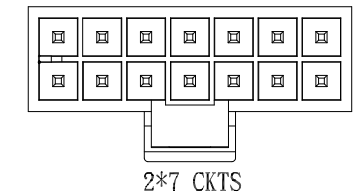
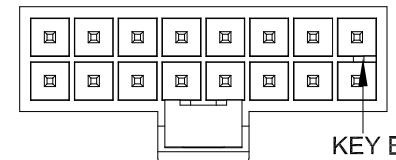
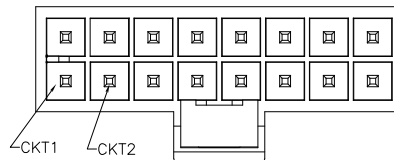
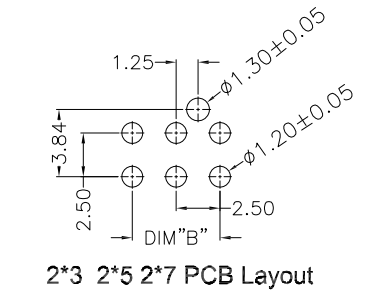
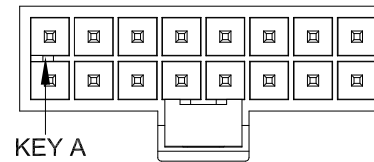
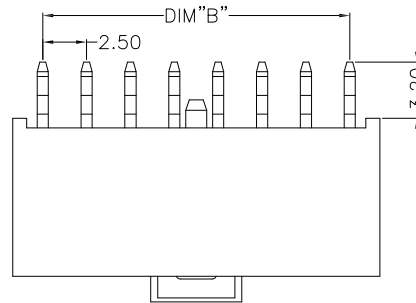
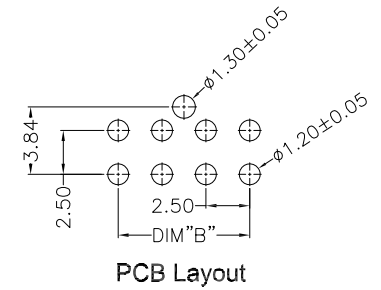
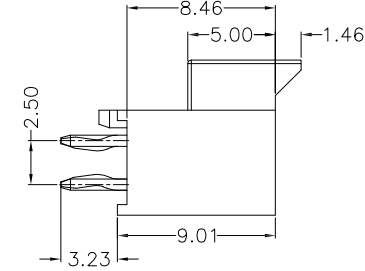
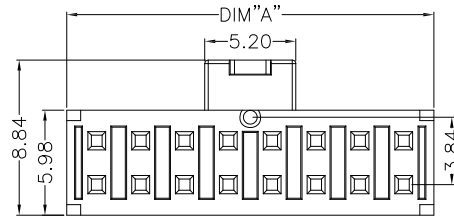

				OPERATION		DRAW		WLY		2019.03.15					
				X.X	±0.40	DESIGN		Jensen	2019.03.15		SOLEPiN 东莞市硕品电子有限公司 Professional connector manufacturer DONGGUAN SOLEPIN ELECTRONICS CO., LTD.				
				X.XX	±0.25	CHECK		Jack	2019.03.15						
				X.XXX	±0.15	APPROVE		Andy	2019.03.15		SIZE	A4	PART NO.	2.5 mm Right vertical header	
AO	NEW			Angle		±1°	UNIT		mm	SCALE	1:1	SHEET	1/1	TITLE:	H2503-XX-X
REV	DATE	MODIFICATION DESCRIPTION		CHANGE	APPROVE	DIM.	TOL	PROJ.	DRAW NO.	SP-671					

客户图

Features:

- 1.4~16 circuits available;
- 2.Material:LCP UL 94V-0 Black/Natural
- 3.PIN Material:Brass tin-plated,SQ0.64;
- 4.Mates with H2502-XX;

Specification:

- Current rating:8A at 10A
- Voltage rating:400V AC(RMS) or 400V DC Max
- Contact resition:10MΩ Max
- Insulation resistace:100MΩ Min
- Dielectric withstanding coltage:1800V AC/minute
- Ambient tempetature rang:-40℃~105℃

Diensional infotmation(mm)

Circuits	DIM A	DIM B
4	5.94	2.50
6	8.44	5.00
8	10.94	7.50
10	13.44	10.00
12	15.94	12.50
14	18.44	15.00
16	20.94	17.50

Ordering Infortmation

Part No	Feature	coloeur
H2504-XX-A	KEY A	Black
H2504-XX-B	KEY B	Natutal

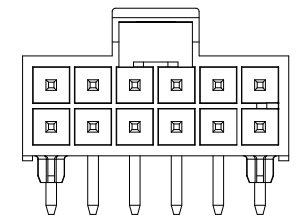
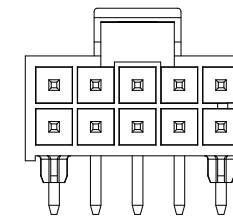
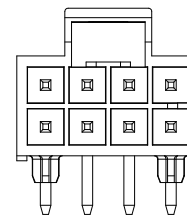
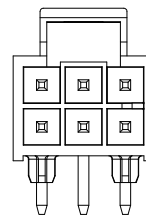
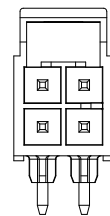
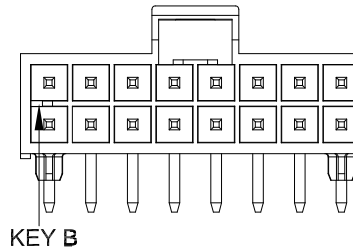
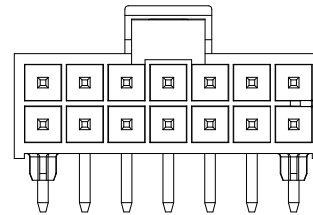
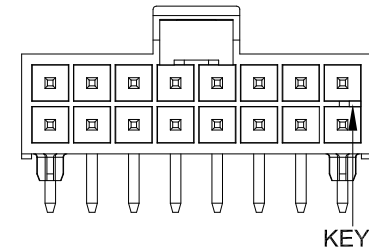
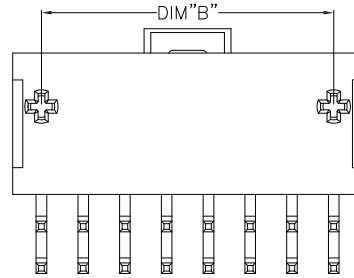
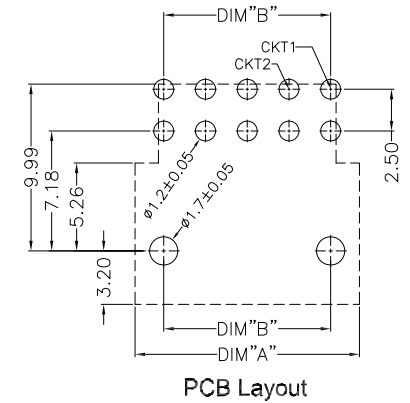
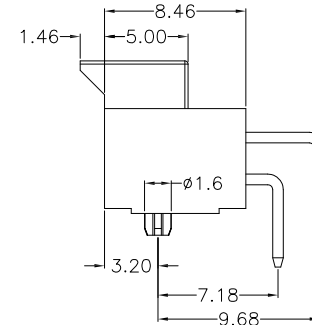
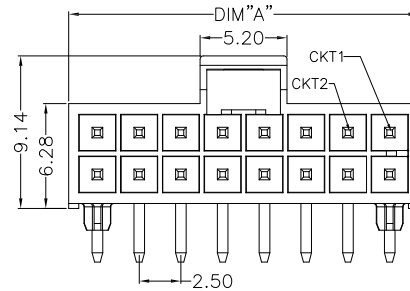

REV		DATE	MODIFICATION DESCRIPTION	CHANGE	APPROVE	OPERATION	DRAW	WLY	2019.03.15				
NEW						X.X ±0.40	DESIGN	Jensen	2019.03.15				
						X.XX ±0.25	CHECK	Jack	2019.03.15				
						X.XXX ±0.15	APPROVE	Andy	2019.03.15				
						Angle ±1°	UNIT	mm	SCALE	1:1			
						DIM. TOL			PROJ.	SOLEPiN	DRAW NO. SP-672		

SOLEPiN 东莞市硕品电子有限公司
Professional connector manufacturer DONGGUAN SOLEPIN ELECTRONICS CO., LTD.

SIZE A4 PART NO. 2.5 mm Right Angle dual Row header
SHEET 1/1 TITLE: H2504-XX-X
PROJ. DRW NO. SP-672