

# 客户图

## NOTES:

1. FINISH:
  - 1.1 TERMINALS: High Conductivity Copper
  - 1.2 USE WITH: 63K2-H HOUSING;
2. ELECTRICAL:
  - 2.1 VOLTAGE RATING: 400V AC/DC;
  - 2.2 CURRENT RATING: 14A AC/DC;
  - 2.3 DIELECTRIC WITHSTANDING VOLTAGE: 1800V AC/MINUTE.
  - 2.4 CONTACT RESISTANCE: 10mΩ MAX.
  - 2.5 INSULATION RESISTANCE: 1000MΩ MIN.
  - 2.6 OPERATION TEMPERATURE: -40°C TO +105°C.

## 3.ORDER INFORMATION:

63K2-T G SN XX

材料规格: 电镀规格: 流水码:  
 G=高导铜 SN=Tin Plating 01=高脚 (High Lever)  
 02=低脚 (Low Lever)

Part No.	Wire range	A	B	C	D
63K2-TGSN01	#20~#22	2.20	2.20	2.10	2.33
63K2-TGSN02	#16~#18	2.80	2.80	2.63	2.90

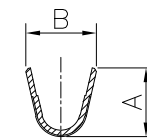
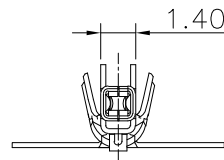
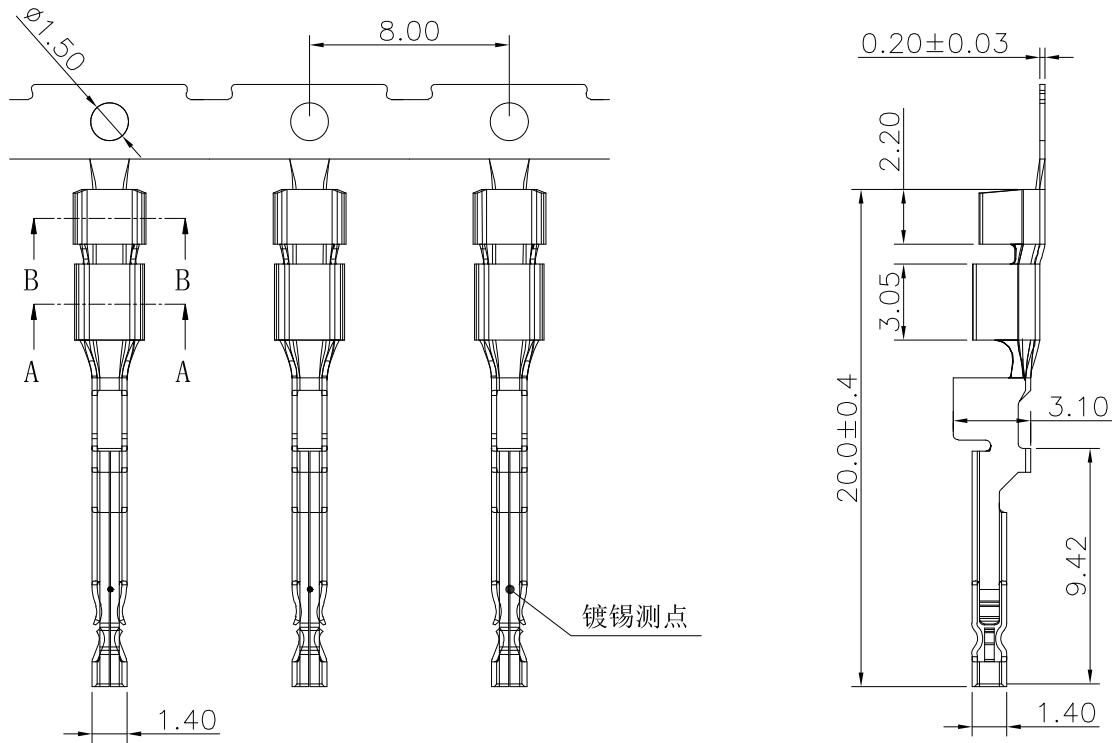

剖面 A-A

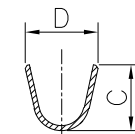

剖面 B-B

				OPERATION		DRAW		WLY		2020.11.20		<b>SOLEPIN</b> 东莞市硕品电子有限公司 Professional connector manufacturer DONGGUAN SOLEPIN ELECTRONICS CO., LTD.					
				X.X	±0.40	DESIGN	Jensen			2020.11.20				SIZE	A4	PART NO.	63K2-TGSNXX
				X.XX	±0.25	CHECK	Jack			2020.11.20				SHEET	1/1	TITLE:	3.50 CRIMP STYLE CONNECTORS
AO		NEW		X.XXX	±0.15	APPROVE	Andy			2020.11.20				PROJ.	☉	DRAW NO.	SP-702
REV	DATE	MODIFICATION DESCRIPTION		CHANGE	APPROVE	DIM.	TOL	UNIT	mm	SCALE	1:1						

# 客户图

## NOTES:

### 1. FINISH:

- 1.1 MATERIAL: PA66 UL 94V-0.
- 1.2 ACCEPTS 63K2T TERMINAL.
- 1.3 MATES WITH 63K2-WD

### 2. ELECTRICAL:

- 2.1 VOLTAGE RATING: 400V AC/DC;
- 2.2 CURRENT RATING: 14A AC/DC;
- 2.3 WITHSTANDING VOLTAGE: 1800V AC/MINUTE.
- 2.4 CONTACT RESISTANCE: 10mΩ MAX.
- 2.5 INSULATION RESISTANCE: 1000MΩ MIN.
- 2.6 OPERATION TEMPERATURE: -40°C TO +105°C.

### 3. ORDER INFORMATION:

63K2-H D XX N A

H=Housing  
D=Double row  
Pin 数码:  
004=2\*02PIN  
~  
024=2\*12PIN

A=A KEY  
B=B KEY  
N=NATURAL  
B=BLACK

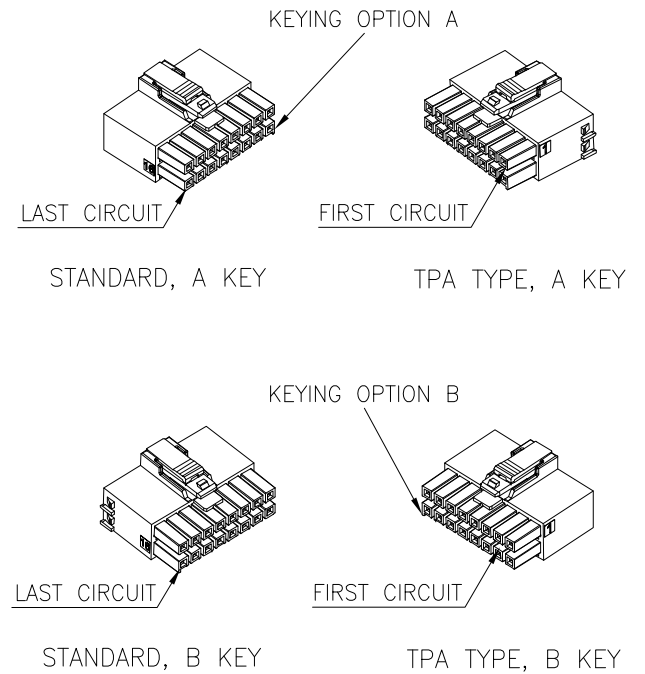
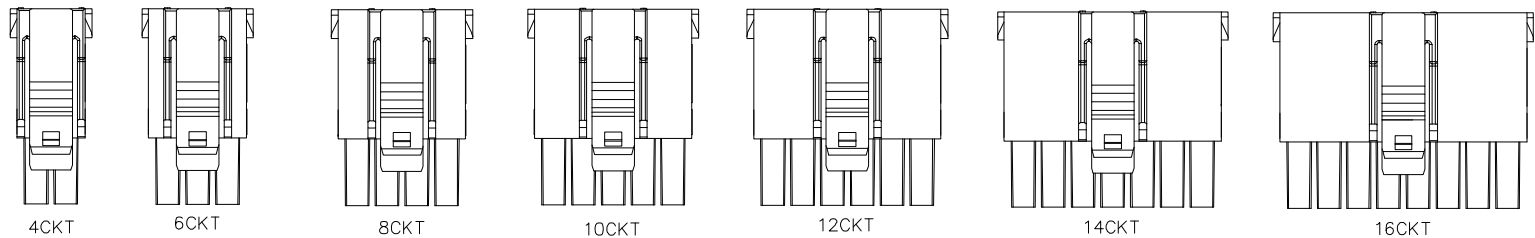
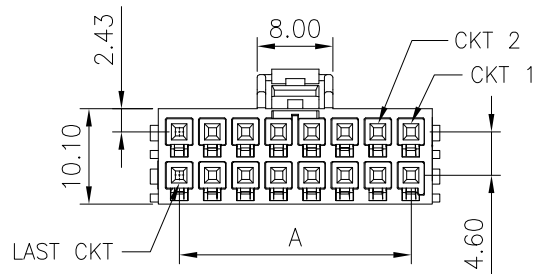
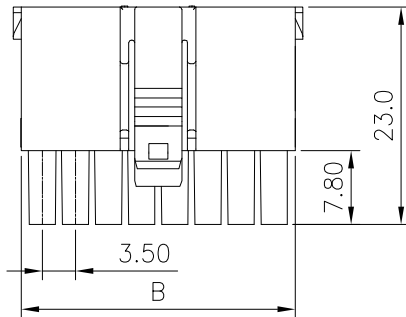
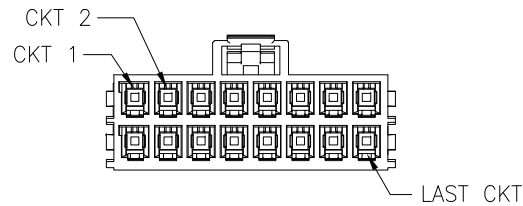

Poles	Dimensions(mm)	
	A	B
004=2*02PIN	3.50	8.00
006=2*03PIN	7.00	11.50
008=2*04PIN	10.50	15.00
010=2*05PIN	14.00	18.50
012=2*06PIN	17.50	22.00
014=2*07PIN	21.00	25.50
016=2*08PIN	24.50	29.00
024=2*12PIN	38.50	43.00

REV	DATE	MODIFICATION DESCRIPTION	CHANGE	APPROVE	OPERATION		DRAW		WLY		<b>SOLEPIN</b> 东莞市硕品电子有限公司 Professional connector manufacturer DONGGUAN SOLEPIN ELECTRONICS CO., LTD.			
					DIM.	TOL	UNIT	mm	SCALE	1:1	SIZE	A4	PART NO.	63K2-HDXXNA
AO		NEW			X.X	±0.40	DESIGN	Jensen	2019.03.02					
					X.XX	±0.25	CHECK	Jack	2019.03.02					
					X.XXX	±0.15	APPROVE	Andy	2019.03.02	SHEET	1/1	TITLE:	3.50mm CRIMP STYLE CONNECTORS	
					Angle	±3°				PROJ.	⌀	DRAW NO.	SP-708	

# 客户图

## NOTES:

1. FINISH:
  - 1.1 MATERIAL: LCP UL 94V-0.
  - 1.2 MATERIAL(PIN): COPPER ALLOY WITH TIN/AU.
  - 1.3 MATES WITH 63K2-HD
2. ELECTRICAL:
  - 2.1 VOLTAGE RATING: 400V AC/DC;
  - 2.2 CURRENT RATING: 14A AC/DC;
  - 2.3 WITHSTANDING VOLTAGE: 1800V AC/MINUTE.
  - 2.4 CONTACT RESISTANCE: 10mΩ MAX.
  - 2.5 INSULATION RESISTANCE: 1000MΩ MIN.
  - 2.6 OPERATION TEMPERATURE: -40°C TO +105°C.

## 3.ORDER INFORMATION:

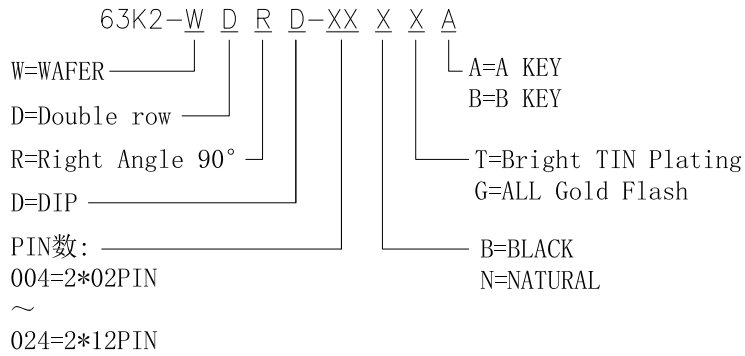

Foles	Dimensions(mm)		
	A	B	C
004=2*02PIN	3.50	8.00	
006=2*03PIN	7.00	11.50	
008=2*04PIN	10.50	15.00	7.00
010=2*05PIN	14.00	18.50	10.50
012=2*06PIN	17.50	22.00	14.00
014=2*07PIN	21.00	25.50	17.50
016=2*08PIN	24.50	29.00	21.00
024=2*12PIN	38.50	43.00	34.00

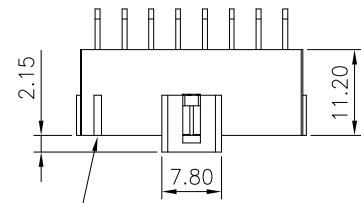
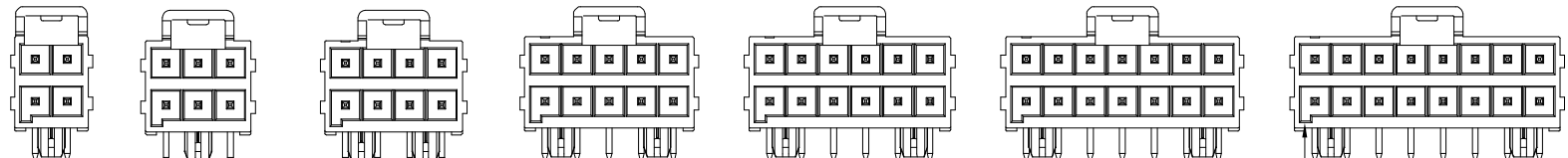

First circuit mark  
(not showing on  
4 and 6 circuits  
series)

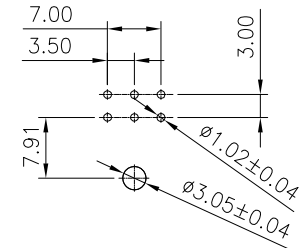

PCB LAYOUT (2\*2~2\*3)

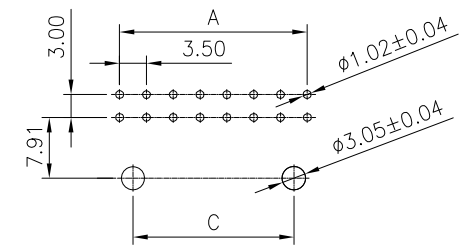

PCB LAYOUT (2\*4~2\*8)

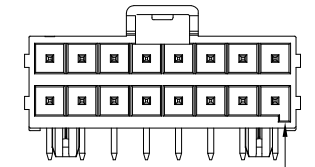
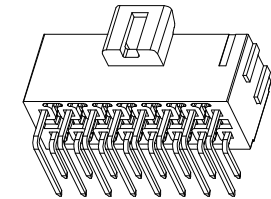
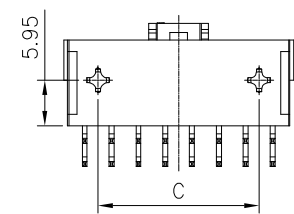
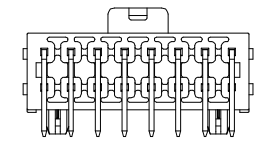
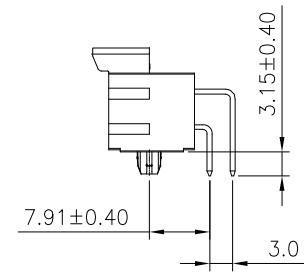
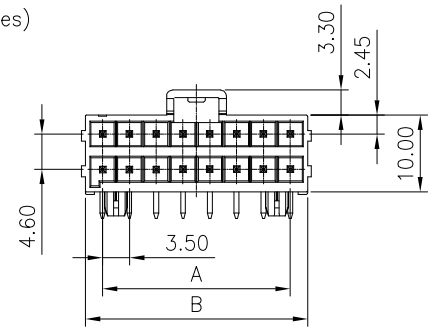

B KEY

A KEY

					OPERATION	DRAW	WLY	2019.03.06	<b>SOLEPIN</b> 东莞市硕品电子有限公司 Professional connector manufacturer DONGGUAN SOLEPIN ELECTRONICS CO., LTD.							
					X.X ±0.40	DESIGN	Jensen	2019.03.06								
					X.XX ±0.25	CHECK	Jack	2019.03.06								
					X.XXX ±0.15	APPROVE	Andy	2019.03.06								
AO			NEW		Angle ±3°				SIZE	A4	PART NO.	63K2-WDRD-XXXXA				
REV	DATE	MODIFICATION DESCRIPTION		CHANGE	APPROVE	DIM.	TOL	UNIT	mm	SCALE	1:1	SHEET	1/1	TITLE:	3.50mm CRIMP STYLE CONNECTORS	
									PROJ.			DRAW NO.	SP-709			

# 客户图

## NOTES:

### 1. FINISH:

- 1.1 MATERIAL: LCP UL 94V-0.
- 1.2 MATERIAL(PIN): COPPER ALLOY WITH TIN/AU.
- 1.3 MATES WITH 63K2-HD

### 2. ELECTRICAL:

- 2.1 VOLTAGE RATING: 400V AC/DC;
- 2.2 CURRENT RATING: 14A AC/DC;
- 2.3 WITHSTANDING VOLTAGE: 1800V AC/MINUTE.
- 2.4 CONTACT RESISTANCE: 10mΩ MAX.
- 2.5 INSULATION RESISTANCE: 1000MΩ MIN.
- 2.6 OPERATION TEMPERATURE: -40°C TO +105°C.

### 3. ORDER INFORMATION:

63K2-W D V D-XX X X A

W=WAFER

D=Double row

V=Vertical 180°

D=DIP

PIN数:

004=2\*02PIN

~  
024=2\*12PIN

A=A KEY  
B=B KEY

T=Bright TIN Plating  
G=ALL Gold Flash

B=BLACK  
N=NATURAL

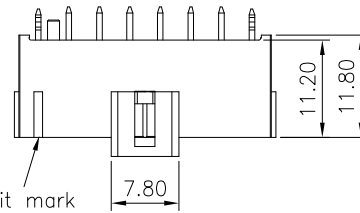

First circuit mark  
(not showing on  
4 and 6 circuits  
series)

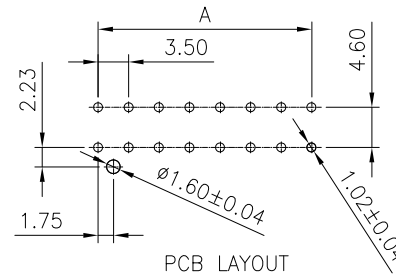
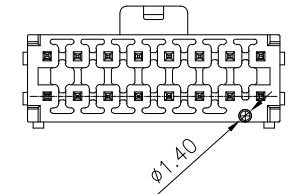
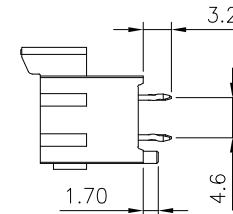
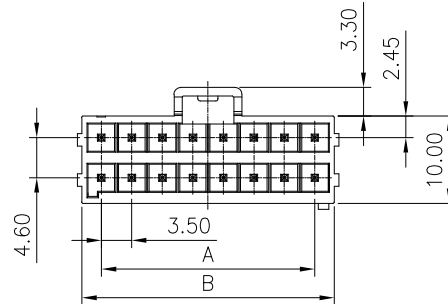
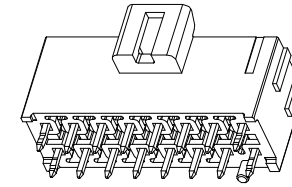

PCB LAYOUT

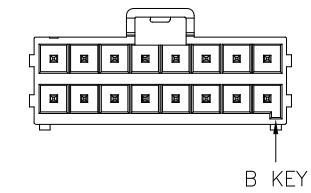

B KEY

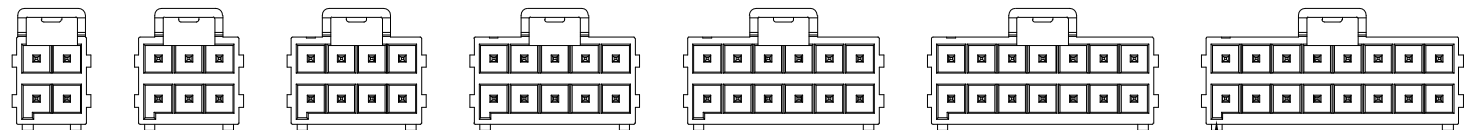
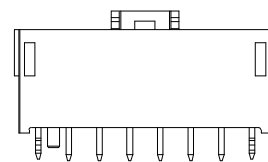

A KEY

Foles	Dimensions(mm)	
	A	B
004=2*02PIN	3.50	8.00
006=2*03PIN	7.00	11.50
008=2*04PIN	10.50	15.00
010=2*05PIN	14.00	18.50
012=2*06PIN	17.50	22.00
014=2*07PIN	21.00	25.50
016=2*08PIN	24.50	29.00
024=2*12PIN	38.50	43.00

OPERATION		DRAW	WLY	2019.03.06
X.X	±0.40	DESIGN	Jensen	2019.03.06
X.XX	±0.25	CHECK	Jack	2019.03.06
X.XXX	±0.15	APPROVE	Andy	2019.03.06
Angle	±3°	UNIT	mm	SCALE
DIM.	TOL	UNIT	mm	SCALE
				1:1

**SOLEPIN** 东莞市硕品电子有限公司  
Professional connector manufacturer DONGGUAN SOLEPIN ELECTRONICS CO., LTD.

REV	DATE	MODIFICATION DESCRIPTION	CHANGE	APPROVE
AO		NEW		

SIZE	A4	PART NO.	63K2-WDVD-XXXXA
SHEET	1/1	TITLE:	3.50mm CRIMP STYLE CONNECTORS
PROJ.	☉	DRAW NO.	SP-710

# 客户图

## NOTES:

### 1. FINISH:

- 1.1 MATERIAL: LCP UL 94V-0.
- 1.2 MATERIAL(PIN): COPPER ALLOY WITH TIN/AU.
- 1.3 MATES WITH 63K2-HD

### 2. ELECTRICAL:

- 2.1 VOLTAGE RATING: 400V AC/DC;
- 2.2 CURRENT RATING: 14A AC/DC;
- 2.3 WITHSTANDING VOLTAGE: 1800V AC/MINUTE.
- 2.4 CONTACT RESISTANCE: 10mΩ MAX.
- 2.5 INSULATION RESISTANCE: 1000MΩ MIN.
- 2.6 OPERATION TEMPERATURE: -40°C TO +105°C.

### 3. ORDER INFORMATION:

63K2-W D V D-XX X X A C

- W=WAFER
- D=Double row
- V=Vertical 180°
- D=DIP
- PIN数:  
004=2\*02PIN  
~  
024=2\*12PIN
- C=带鱼叉
- A=A KEY
- B=B KEY
- T=Bright TIN Plating
- G=ALL Gold Flash
- B=BLACK
- N=NATURAL

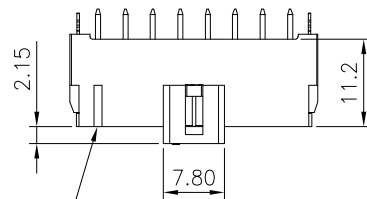

First circuit mark  
(not showing on  
4 and 6 circuits  
series)

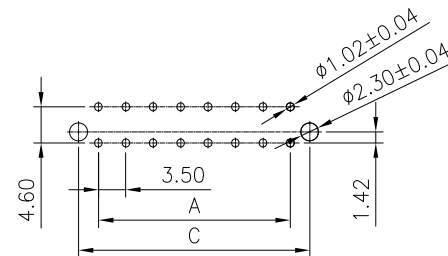
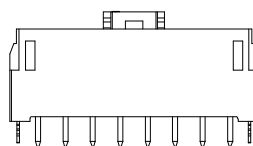
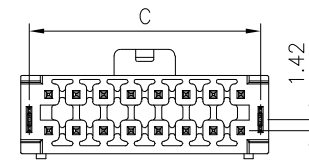
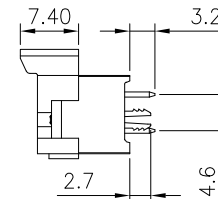
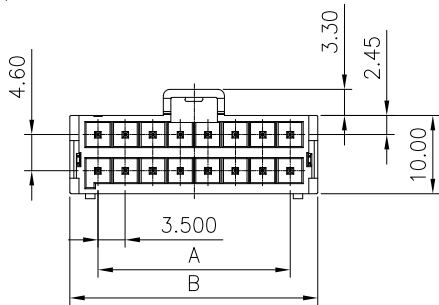
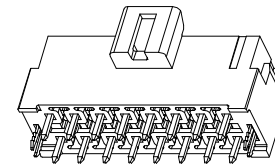

PCB Layout

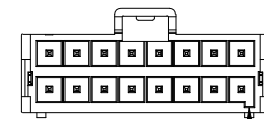

B KEY

Foles	Dimensions(mm)		
	A	B	C
004=2*02PIN	3.50	10.60	8.50
006=2*03PIN	7.00	14.10	12.00
008=2*04PIN	10.50	17.60	15.50
010=2*05PIN	14.00	21.10	19.00
012=2*06PIN	17.50	24.60	22.50
014=2*07PIN	21.00	28.10	26.00
016=2*08PIN	24.50	31.60	29.50
024=2*12PIN	38.50	45.60	43.50

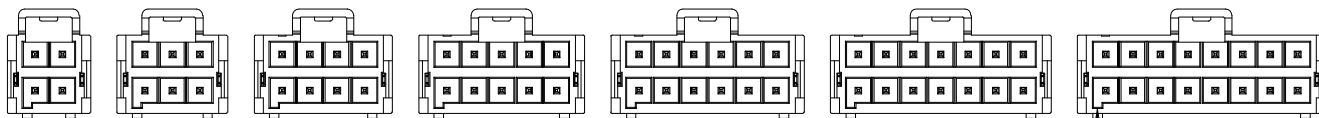

A KEY

				OPERATION		DRAW		WLY		2019.03.06		<b>SOLEPIN</b> 东莞市硕品电子有限公司 Professional connector manufacturer DONGGUAN SOLEPIN ELECTRONICS CO., LTD.			
				X.X	±0.40	DESIGN	Jensen				2019.03.06			SIZE	A4
				X.XX	±0.25	CHECK	Jack				2019.03.06	SHEET	1/1	TITLE:	3.50mm CRIMP STYLE CONNECTORS
AO		NEW		X.XXX	±0.15	APPROVE	Andy				2019.03.06	PROJ.	PROJ.	DRAW NO.	SP-711
REV	DATE	MODIFICATION DESCRIPTION				DIM.	TOL	UNIT	mm	SCALE	1:1				

# 客户图

## NOTES:

### 1. FINISH:

- 1.1 MATERIAL: PA66 UL 94V-0.
- 1.2 MATES WITH 63K2-H

### 2. ELECTRICAL:

- 2.1 VOLTAGE RATING: 400V AC/DC;
- 2.2 CURRENT RATING: 14A AC/DC;
- 2.3 WITHSTANDING VOLTAGE: 1800V AC/MINUTE.
- 2.4 CONTACT RESISTANCE: 10mΩ MAX.
- 2.5 INSULATION RESISTANCE: 1000MΩ MIN.
- 2.6 OPERATION TEMPERATURE: -40°C TO +105°C.

### 3. ORDER INFORMATION:

63K2-S XX X

Pin数码: \_\_\_\_\_

颜色: \_\_\_\_\_

02=2PIN

N=Natural

~

B=Black

12=12PIN

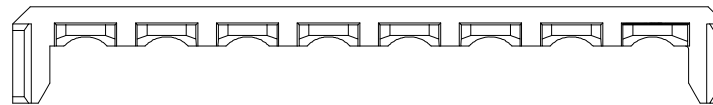
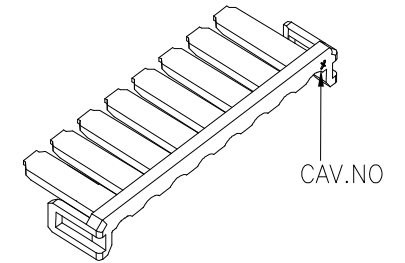
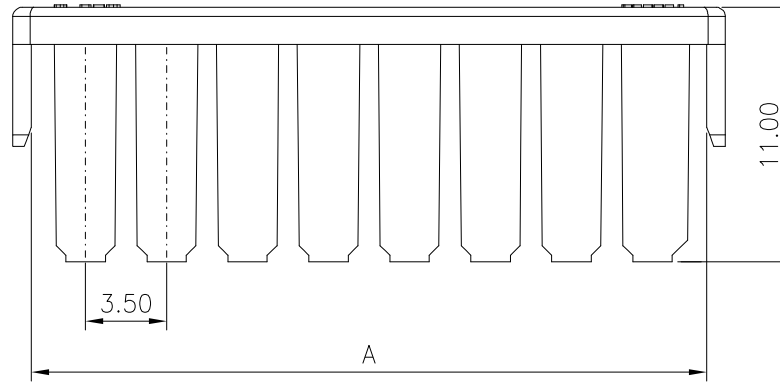

Poles	Dimensions(mm)	
	A	
02	8.20	
03	11.70	
04	15.20	
05	18.70	
06	22.20	
07	25.70	
08	29.20	
12	43.20	

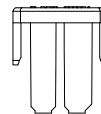

2P

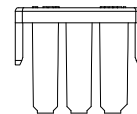

3P

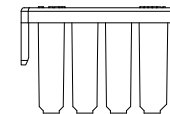

4P

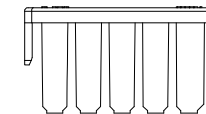

5P

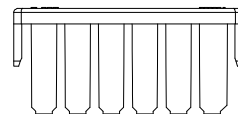

6P

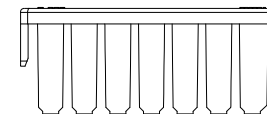

7P

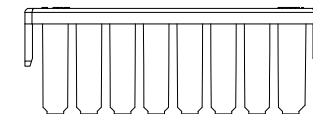

8P

					OPERATION	DRAW	WLY	2019.02.03	<b>SOLEPIN</b> 东莞市硕品电子有限公司 Professional connector manufacturer DONGGUAN SOLEPIN ELECTRONICS CO., LTD.				
					X.X ±0.40	DESIGN	Jensen	2019.02.03					
					X.XX ±0.25	CHECK	Jack	2019.02.03	SIZE	A4	PART NO.	63K2-SXXX	
AO		NEW			X.XXX ±0.15	APPROVE	Andy	2019.02.03	SHEET	1/1	TITLE:	3.50mm CRIMP STYLE CONNECTORS	
REV	DATE	MODIFICATION DESCRIPTION	CHANGE	APPROVE	Angle ±3°	UNIT	mm	SCALE	1:1	PROJ.	☉	DRAW NO.	SP-707
					DIM. TOL								

# 客户图

## NOTES:

1. FINISH:
  - 1.1 TERMINALS: High Conductivity Copper
  - 1.2 USE WITH: 63K2-H HOUSING;
2. ELECTRICAL:
  - 2.1 VOLTAGE RATING: 400V AC/DC;
  - 2.2 CURRENT RATING: 14A AC/DC;
  - 2.3 DIELECTRIC WITHSTANDING VOLTAGE: 1800V AC/MINUTE.
  - 2.4 CONTACT RESISTANCE: 10mΩ MAX.
  - 2.5 INSULATION RESISTANCE: 1000MΩ MIN.
  - 2.6 OPERATION TEMPERATURE: -40°C TO +105°C.

## 3.ORDER INFORMATION:

63K2-T G SN XX

材料规格: 电镀规格: 流水码:  
 G=高导铜 SN=Tin Plating 01=高脚 (High Lever)  
 02=低脚 (Low Lever)

Part No.	Wire range	A	B	C	D
63K2-TGSN01	#20~#22	2.20	2.20	2.10	2.33
63K2-TGSN02	#16~#18	2.80	2.80	2.63	2.90

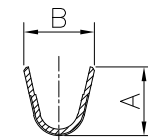
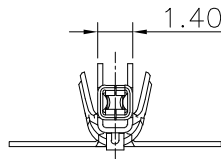
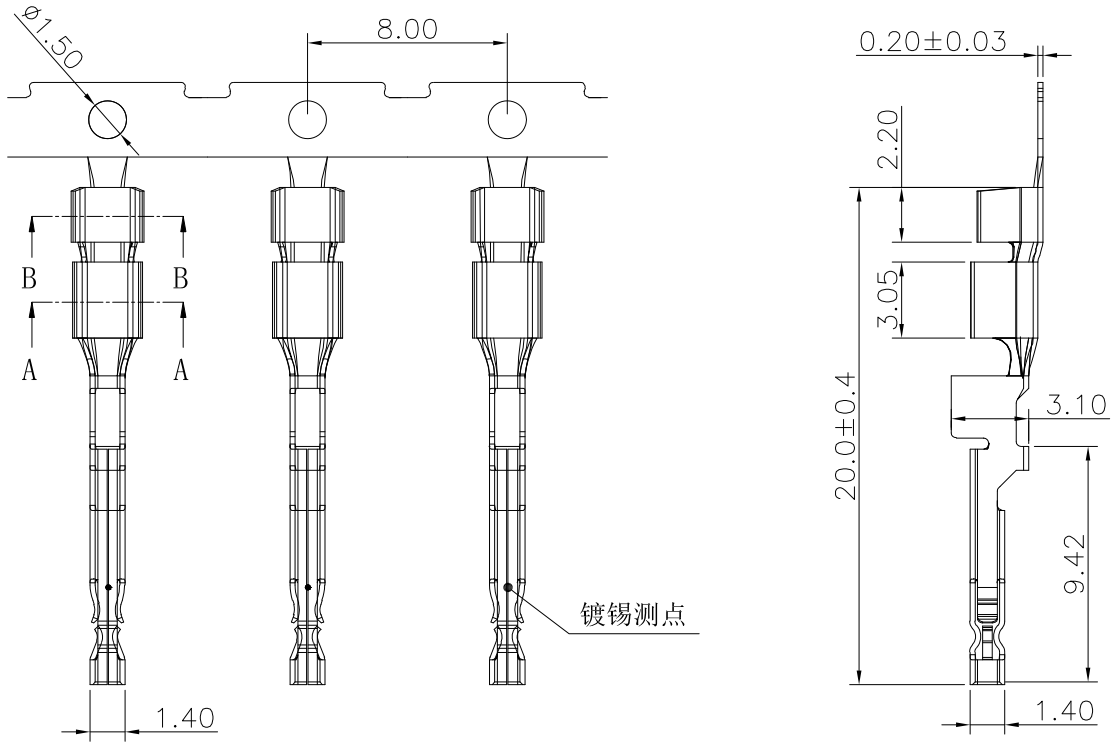

剖面 A-A

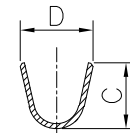

剖面 B-B

REV		DATE	MODIFICATION DESCRIPTION	CHANGE	APPROVE	DIM.	TOL	UNIT	mm	SCALE	1:1	PROJ.	SIZE	A4	PART NO.	63K2-TGSNXX
AO			NEW			Angle	±3°	APPROVE	Andy	2020.11.20		SHEET	1/1	TITLE:	3.50 CRIMP STYLE CONNECTORS	
													PROJ.	⌀	DRAW NO.	SP-702

**SOLEPIN** 东莞市硕品电子有限公司  
 Professional connector manufacturer DONGGUAN SOLEPIN ELECTRONICS CO., LTD.

# 客户图

## NOTES:

### 1. FINISH:

- 1.1 MATERIAL: PA66 UL 94V-0.
- 1.2 ACCEPTS 63K2T TERMINAL.
- 1.3 MATES WITH 63K2-WO

### 2. ELECTRICAL:

- 2.1 VOLTAGE RATING: 400V AC/DC;
- 2.2 CURRENT RATING: 14A AC/DC;
- 2.3 WITHSTANDING VOLTAGE: 1800V AC/MINUTE.
- 2.4 CONTACT RESISTANCE: 10mΩ MAX.
- 2.5 INSULATION RESISTANCE: 1000MΩ MIN.
- 2.6 OPERATION TEMPERATURE: -40°C TO +105°C.

### 3. ORDER INFORMATION:

63K2-H O XX N A

H=Housing

O=One row

Pin数码:

002=02PIN

~

012=12PIN

A=A KEY

B=B KEY

N=NATURAL

B=BLACK

Poles	Dimensions(mm)	
	A	B
02	3.50	8.00
03	7.00	11.50
04	10.50	15.00
05	14.00	18.50
06	17.50	22.00
07	21.00	25.50
08	24.50	29.00
12	38.50	43.00

STANDARD, A KEY

TPA TYPE, A KEY

STANDARD, B KEY

TPA TYPE, B KEY

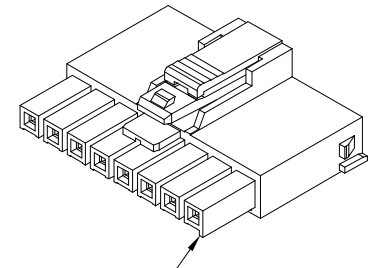
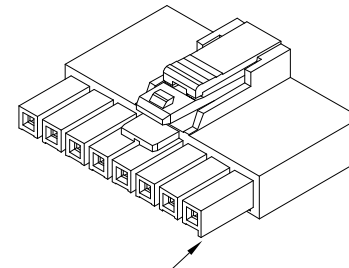
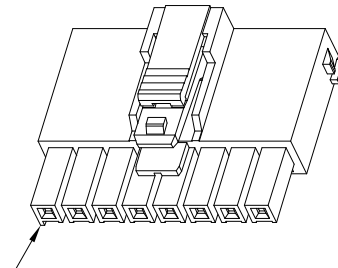
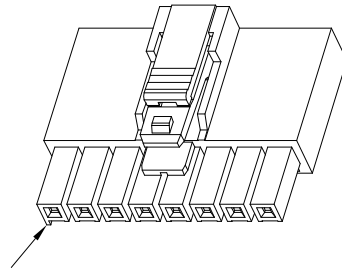
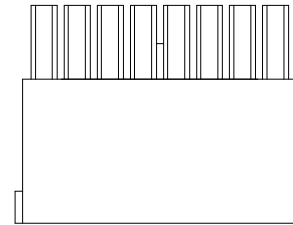
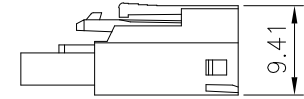
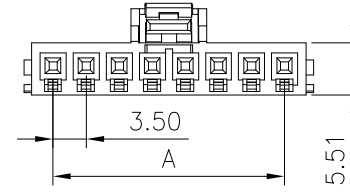
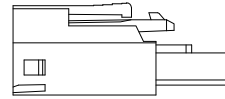
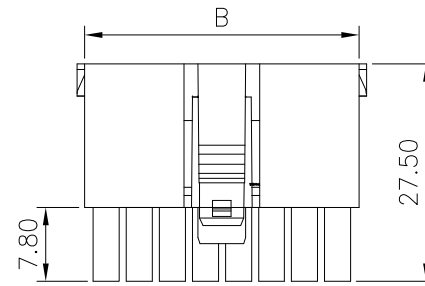

REV	DATE	MODIFICATION DESCRIPTION	CHANGE	APPROVE	OPERATION	DRAW	WLY	SCALE	UNIT	mm	SCALE	1:1	PROJ.	SIZE	A4	PART NO.	63K2-HOXXNA
AO		NEW			X.X ±0.40	DESIGN	Jensen	2019.02.03						SHEET	1/1	TITLE:	3.50mm CRIMP STYLE CONNECTORS
					X.XX ±0.25	CHECK	Jack	2019.02.03						PROJ.	Φ	DRAW NO.	SP-703
					X.XXX ±0.15	APPROVE	Andy	2019.02.03									
					Angle ±3°												
					DIM. TOL												

**SOLEPIN** 东莞市硕品电子有限公司  
Professional connector manufacturer DONGGUAN SOLEPIN ELECTRONICS CO., LTD.

SIZE A4 PART NO. 63K2-HOXXNA  
SHEET 1/1 TITLE: 3.50mm CRIMP STYLE CONNECTORS  
PROJ. Φ DRAW NO. SP-703



# 客户图

## NOTES:

### 1. FINISH:

- 1.1 MATERIAL: LCP UL 94V-0.
- 1.2 MATERIAL(PIN): COPPER ALLOY WITH TIN/AU.
- 1.3 MATES WITH 63K2-HO

### 2. ELECTRICAL:

- 2.1 VOLTAGE RATING: 400V AC/DC;
- 2.2 CURRENT RATING: 14A AC/DC;
- 2.3 WITHSTANDING VOLTAGE: 1800V AC/MINUTE.
- 2.4 CONTACT RESISTANCE: 10mΩ MAX.
- 2.5 INSULATION RESISTANCE: 1000MΩ MIN.
- 2.6 OPERATION TEMPERATURE: -40°C TO +105°C.

### 3. ORDER INFORMATION:

63K2-W O R D-XX X X A

W=WAFER

O=One row

R=Right Angle 90°

D=DIP

PIN数:

002=02PIN

012=12PIN

A=A KEY  
B=B KEY

T=Bright TIN Plating  
G=ALL Gold Flash

B=BLACK  
N=NATURAL

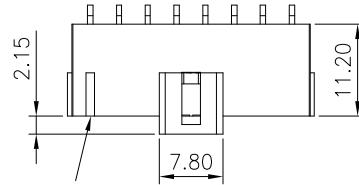

First circuit mark  
(not showing on  
4 and 6 circuits  
series)

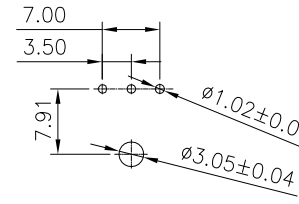

PCB LAYOUT (2~3PRI)

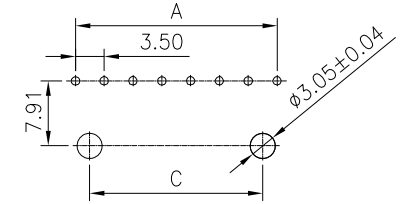

PCB LAYOUT (4~8PRI)

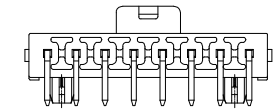
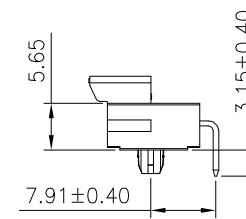
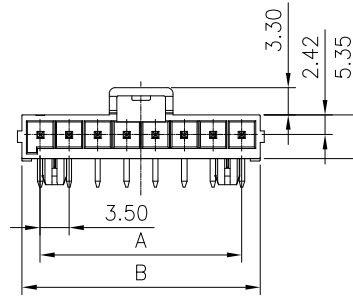

B KEY

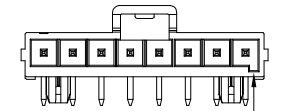
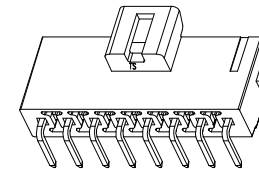
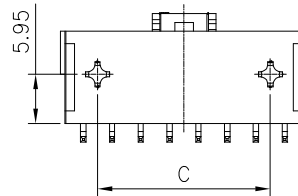

A KEY

Foles	Dimensions(mm)		
	A	B	C
02	3.50	8.00	
03	7.00	11.50	
04	10.50	15.00	7.00
05	14.00	18.50	10.50
06	17.50	22.00	14.00
07	21.00	25.50	17.50
08	24.50	29.00	21.00
12	38.50	43.00	34.00

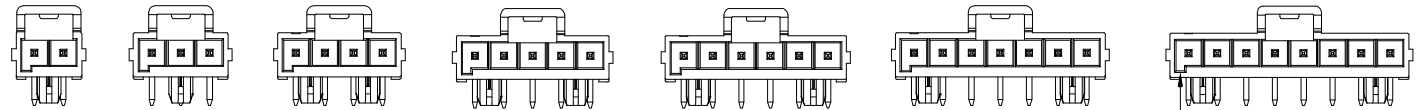

REV	DATE	MODIFICATION DESCRIPTION	CHANGE	APPROVE	OPERATION		DRAW		WLY		2019.03.06				
					X.X	±0.40	DESIGN	Jensen	2019.03.06						
					X.XX	±0.25	CHECK	Jack	2019.03.06			SIZE	A4	PART NO.	63K2-WORD-XXXXA
					X.XXX	±0.15	APPROVE	Andy	2019.03.06			SHEET	1/1	TITLE:	3.50mm CRIMP STYLE CONNECTORS
					Angle	±3°	UNIT		mm	SCALE	1:1	PROJ.	⌀	DRAW NO.	SP-704
AO		NEW			DIM.	TOL									

**SOLEPIN** 东莞市硕品电子有限公司  
Professional connector manufacturer DONGGUAN SOLEPIN ELECTRONICS CO., LTD.

SIZE A4 PART NO. 63K2-WORD-XXXXA  
SHEET 1/1 TITLE: 3.50mm CRIMP STYLE CONNECTORS  
PROJ. ⌀ DRAW NO. SP-704

# 客户图

## NOTES:

1. FINISH:
  - 1.1 MATERIAL: LCP UL 94V-0.
  - 1.2 MATERIAL(PIN): COPPER ALLOY WITH TIN/AU.
  - 1.3 MATES WITH 63K2-H0
2. ELECTRICAL:
  - 2.1 VOLTAGE RATING: 400V AC/DC;
  - 2.2 CURRENT RATING: 14A AC/DC;
  - 2.3 WITHSTANDING VOLTAGE: 1800V AC/MINUTE.
  - 2.4 CONTACT RESISTANCE: 10mΩ MAX.
  - 2.5 INSULATION RESISTANCE: 1000MΩ MIN.
  - 2.6 OPERATION TEMPERATURE: -40°C TO +105°C.

## 3.ORDER INFORMATION:

63K2-W Q V D-XX X X A

- W=WAFER
- Q=One row
- V=Vertical 180°
- D=DIP
- PIN数: 002=02PIN  
~  
012=12PIN
- A=A KEY
- B=B KEY
- T=Bright TIN Plating
- G=ALL Gold Flash
- B=BLACK
- N=NATURAL

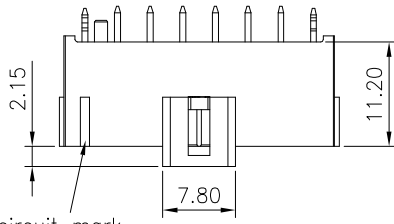

First circuit mark  
(not showing on  
4 and 6 circuits  
series)

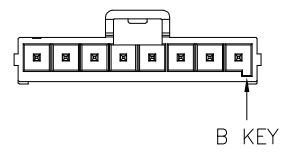
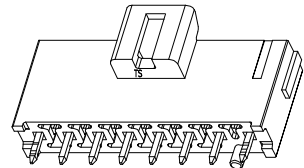
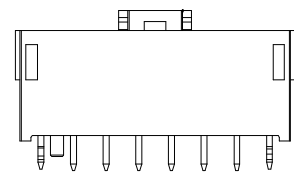
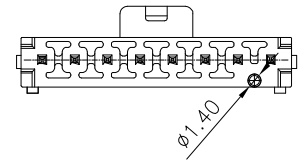
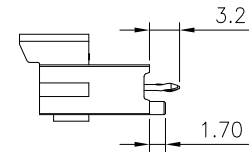
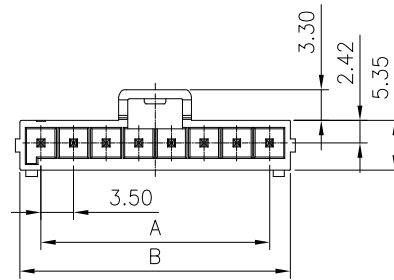
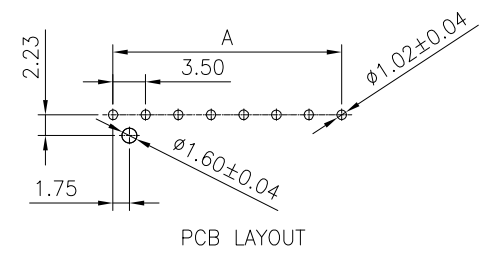

Foles	Dimensions(mm)	
	A	B
02	3.50	8.00
03	7.00	11.50
04	10.50	15.00
05	14.00	18.50
06	17.50	22.00
07	21.00	25.50
08	24.50	29.00
12	38.50	43.00

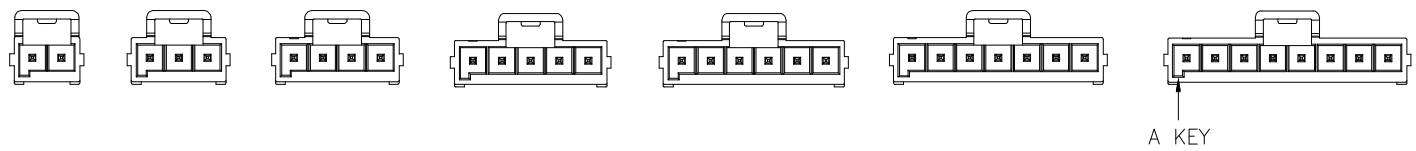

OPERATION		DRAW	WLY	2019.03.06
X.X	±0.40	DESIGN	Jensen	2019.03.06
X.XX	±0.25	CHECK	Jack	2019.03.06
X.XXX	±0.15	APPROVE	Andy	2019.03.06
Angle	±3°	UNIT	mm	SCALE
DIM.	TOL	UNIT	mm	SCALE

**SOLEPIN** 东莞市硕品电子有限公司  
Professional connector manufacturer DONGGUAN SOLEPIN ELECTRONICS CO., LTD.

SIZE	A4	PART NO.	63K2-WQVD-XXXXA
SHEET	1/1	TITLE:	3.50mm CRIMP STYLE CONNECTORS
PROJ.	⌀	DRAW NO.	SP-705

REV	DATE	MODIFICATION DESCRIPTION	CHANGE	APPROVE
AO		NEW		

# 客户图

## NOTES:

### 1. FINISH:

- 1.1 MATERIAL: LCP UL 94V-0.
- 1.2 MATERIAL(PIN): COPPER ALLOY WITH TIN/AU.
- 1.3 MATES WITH 63K2-HO

### 2. ELECTRICAL:

- 2.1 VOLTAGE RATING: 400V AC/DC;
- 2.2 CURRENT RATING: 14A AC/DC;
- 2.3 WITHSTANDING VOLTAGE: 1800V AC/MINUTE.
- 2.4 CONTACT RESISTANCE: 10mΩ MAX.
- 2.5 INSULATION RESISTANCE: 1000MΩ MIN.
- 2.6 OPERATION TEMPERATURE: -40°C TO +105°C.

### 3. ORDER INFORMATION:

63K2-W O V D-XX X X A C

W=WAFER

O=ONE ROW

V=Vertical 180°

D=DIP

PIN数:

002=02PIN

012=12PIN

C=带鱼叉

A=A KEY

B=B KEY

T=Bright TIN Plating

G=ALL Gold Flash

B=BLACK

N=NATURAL

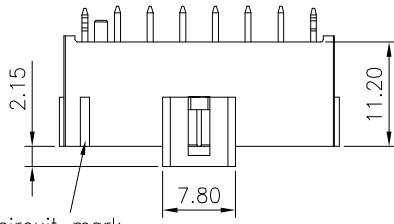

First circuit mark  
(not showing on  
4 and 6 circuits  
series)

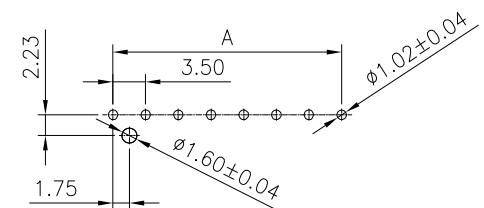

PCB LAYOUT

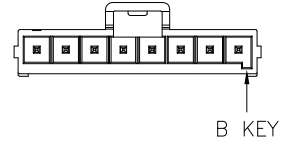
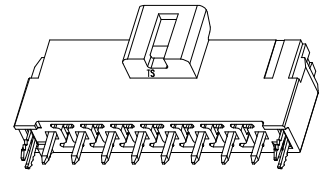
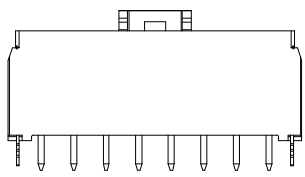
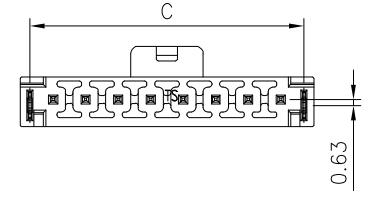
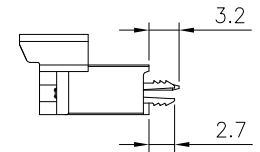
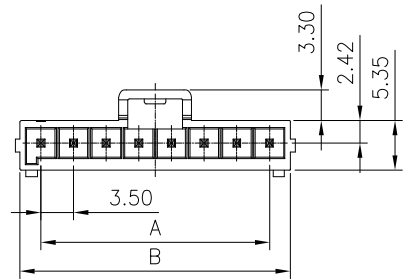

Foles	Dimensions(mm)		
	A	B	C
02	3.50	10.60	8.50
03	7.00	14.10	12.00
04	10.50	17.60	15.50
05	14.00	21.10	19.00
06	17.50	24.60	22.50
07	21.00	28.10	26.00
08	24.50	31.60	29.50
12	38.50	45.60	43.50

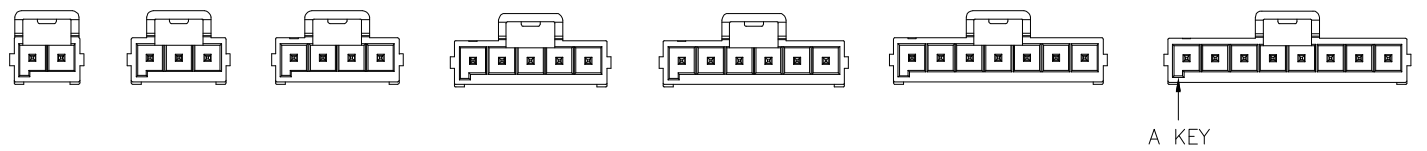

OPERATION		DRAW	WLY	2019.03.06
X.X	±0.40	DESIGN	Jensen	2019.03.06
X.XX	±0.25	CHECK	Jack	2019.03.06
X.XXX	±0.15	APPROVE	Andy	2019.03.06
Angle	±3°	UNIT	mm	SCALE
DIM.	TOL	UNIT	mm	SCALE
				1:1

**SOLEPIN** 东莞市硕品电子有限公司  
Professional connector manufacturer DONGGUAN SOLEPIN ELECTRONICS CO., LTD.

REV	DATE	MODIFICATION DESCRIPTION	CHANGE	APPROVE
AO		NEW		

SIZE	A4	PART NO.	63K2-WOVD-XXXXAC
SHEET	1/1	TITLE:	3.50mm CRIMP STYLE CONNECTORS
PROJ.	☉	DRAW NO.	SP-706

# 客户图

## NOTES:

1. FINISH:
  - 1.1 MATERIAL: PA66 UL 94V-0.
  - 1.2 MATES WITH 63K2-H
2. ELECTRICAL:
  - 2.1 VOLTAGE RATING: 400V AC/DC;
  - 2.2 CURRENT RATING: 14A AC/DC;
  - 2.3 WITHSTANDING VOLTAGE: 1800V AC/MINUTE.
  - 2.4 CONTACT RESISTANCE: 10mΩ MAX.
  - 2.5 INSULATION RESISTANCE: 1000MΩ MIN.
  - 2.6 OPERATION TEMPERATURE: -40°C TO +105°C.
3. ORDER INFORMATION:

63K2-S XX X

Pin数码:      颜色:  
 02=2PIN      N=Natural  
 ~              B=Black  
 12=12PIN

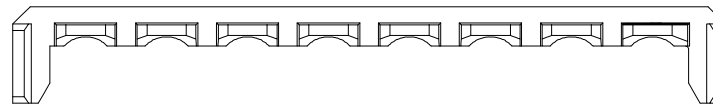
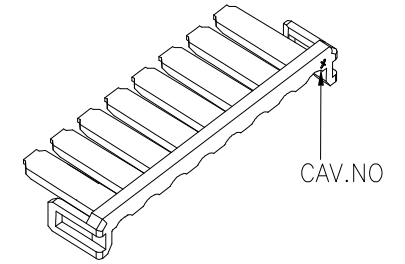
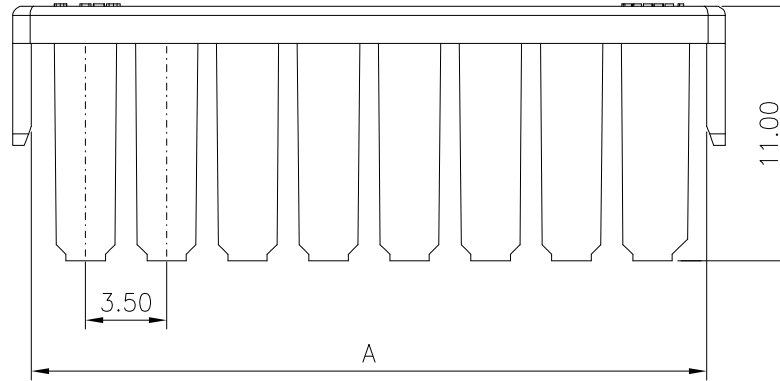

Poles	Dimensions(mm)	
	A	
02	8.20	
03	11.70	
04	15.20	
05	18.70	
06	22.20	
07	25.70	
08	29.20	
12	43.20	

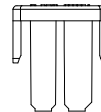

2P

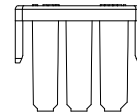

3P

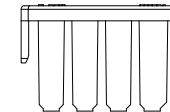

4P

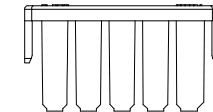

5P

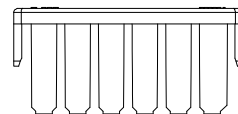

6P

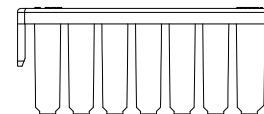

7P

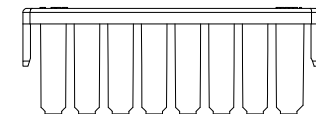

8P

					OPERATION	DRAW	WLY	2019.02.03	<b>SOLEPIN</b> 东莞市硕品电子有限公司 Professional connector manufacturer DONGGUAN SOLEPIN ELECTRONICS CO., LTD.					
					X.X ±0.40	DESIGN	Jensen	2019.02.03						
					X.XX ±0.25	CHECK	Jack	2019.02.03						
					X.XXX ±0.15	APPROVE	Andy	2019.02.03						
AO		NEW			Angle ±3°				SIZE	A4	PART NO.	63K2-SXXX		
REV	DATE	MODIFICATION DESCRIPTION	CHANGE	APPROVE	DIM. TOL	UNIT	mm	SCALE	1:1	SHEET	1/1	TITLE:	3.50mm CRIMP STYLE CONNECTORS	
									PROJ.	☯	DRAW NO.	SP-707		